

DO NOT SCALE FROM THIS DRAWING. USE FIGURED DIMENSIONS IN ALL CASES. VERIFY DIMENSIONS ON SITE AND REPORT ANY DISCREPANCIES TO THE DESIGNERS IMMEDIATELY.  
THIS DRAWING TO BE READ IN CONJUNCTION WITH THE DESIGNERS SPECIFICATION.  
© THIS DRAWING IS COPYRIGHT AND MAY ONLY BE REPRODUCED WITH THE DESIGNERS PERMISSION.

- NOTES:**
- ALL CONSTRUCTION PRODUCTS COVERED BY A HARMONIZED EUROPEAN PRODUCT STANDARD SHALL HAVE DECLARATION OF PERFORMANCE AND A CE MARK IN COMPLIANCE WITH THE CONSTRUCTION PRODUCT REGULATION (EU) NO. 395/2011 CPR.
  - ALL EXTERNAL STEELWORK GALVANISED TO IS EN ISO 1461.
  - ALL COVERS, GRATINGS & FRAMES IN HARDSTANDING AREAS ARE TO BE A MINIMUM OF CLASS D400 DUCTILE IRON IN ACCORDANCE WITH BS EN 124
  - ALL HATCHING IS INDICATIVE ONLY
  - ALL CLADDING, DOORS, LOUVERS & VENTS TO BE RAL6007, BOTTLE GREEN IN COLOUR

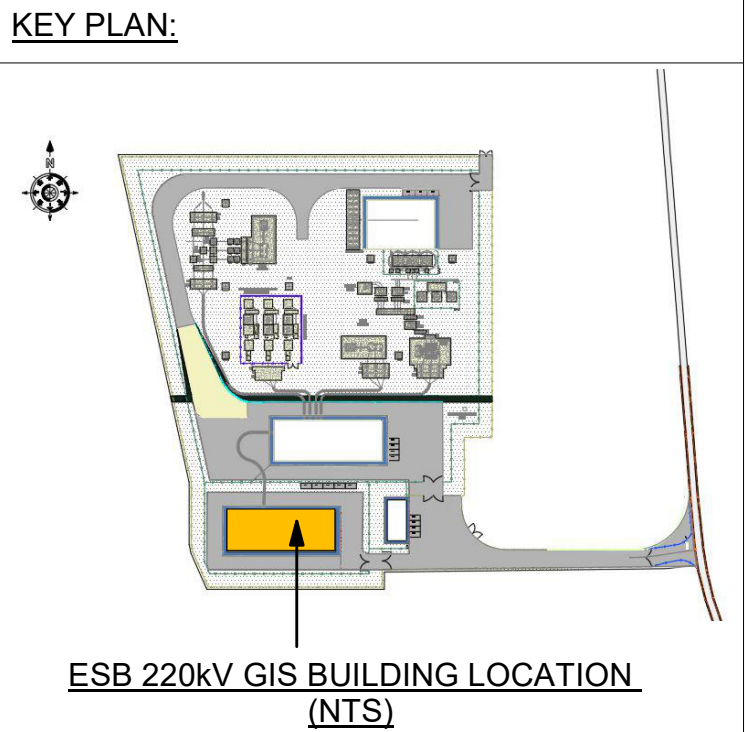

REV	DATE	DESCRIPTION	BY	APP
02	25.11.24	ISSUED FOR PLANNING	EP	IB
01	18.11.24	ISSUED FOR PLANNING	EP	IB

PROJECT: SCERDE ROCKS OFFSHORE WIND FARM

TITLE: PROPOSED LAYOUT ESB 220kV GIS BUILDING – SECTIONS



DRAWN: TM	CHECKED: EP	APPROVED: IB
PROJECT NUMBER: 24204	DATE: NOV' 2024	SCALE @ A1: As indicated
STATUS DESCRIPTION: FOR PLANNING		STATUS: S4
DRAWING NUMBER: IRE1-HMV-ONS-EL-PD-1006		REV: 02